



## Evacuator Synergy + TS Base Station Instructions

### SYSTEM SET UP

Evacuator Synergy + Alert System Specification and user operating instructions.

Thank you for choosing the Evacuator Synergy + Wireless Alert system. In order for you to realise the full potential and reliability of this Category One Wireless system it is vitally important that you read this user manual in **full** before attempting to use the system. Failure to understand the correct installation method and functions of the system may lead to intermittent and unreliable connectivity.

We would be delighted to assist all Evacuator Alarm clients with free Telephone Support during office normal hours. For assistance please contact our Technical Support Team on 0845 130 7258 or alternatively email us on [technical@evacuatorialarms.com](mailto:technical@evacuatorialarms.com)

#### Specification Overview (All models)

Mains Powered Evacuator Synergy + TS Base Station which enables users to receive addressable alerts, check system status and create zones from their Evacuator Synergy + System. Base Station is navigated using the touch screen, three buttons & Manual Call Point. **Indoor Use only, Mains Powered Device**

#### Fitting the Antenna

The antenna should now be fitted to the Silver TNC docking point located on the top of the unit. The Antenna should be placed over the TNC connector and twisted in clockwise motion until it locates into place. Test that it has been located correctly by gently pulling on the Antenna in an outwards motion.

#### Connecting Power Supply

Attach the provided 3 pin plug adapter to the power supply. Now plug in the 3.5mm jack into the socket on the top edge of the product. Now Switch on the wall socket, the unit will power up by itself.

Please use the supplied 5v 2a power supply provided, failure to do so may damage the operation of the product.



# EVACUATOR

Site Alarms

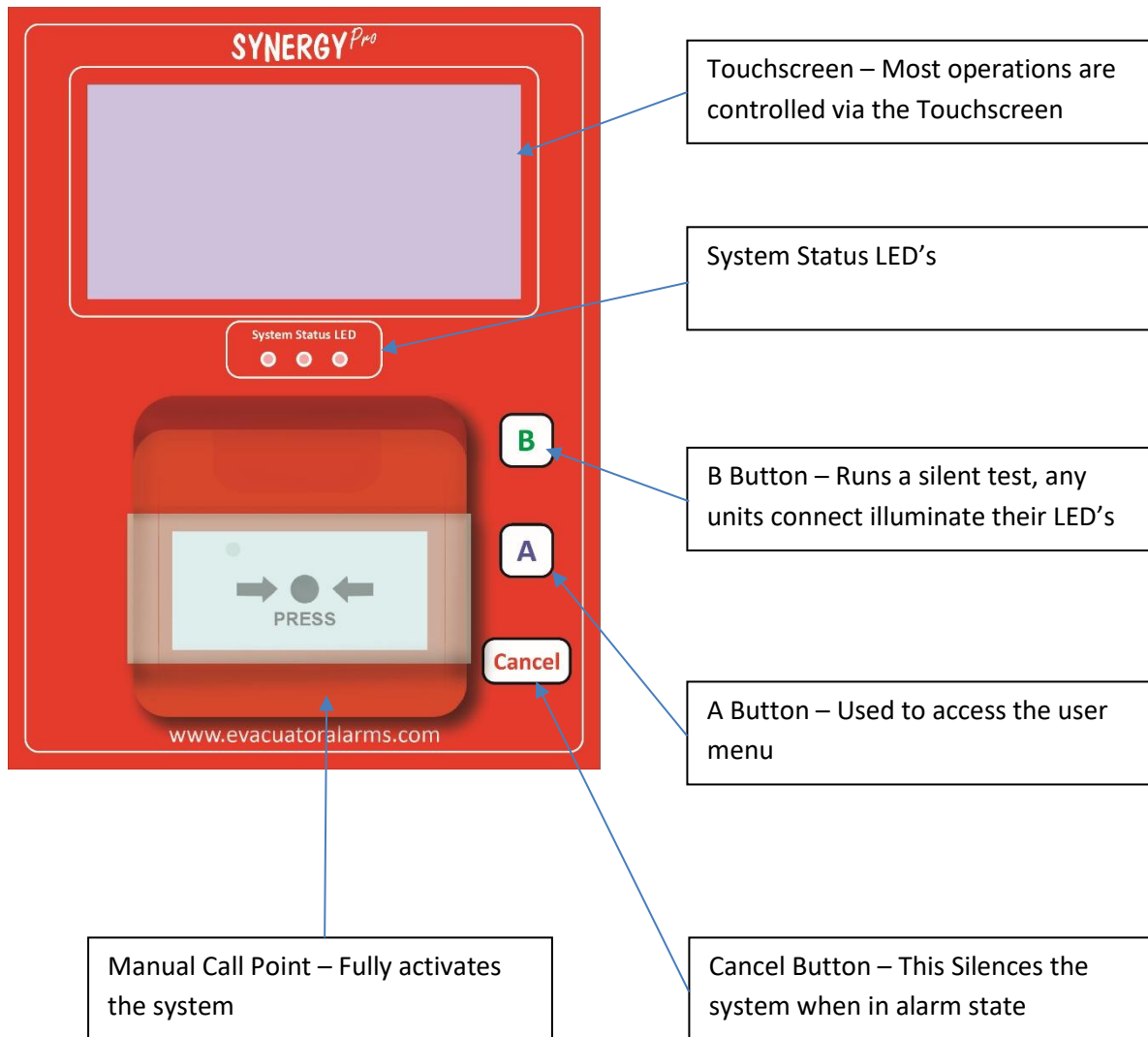

## TS BASE STATION HOME SCREEN

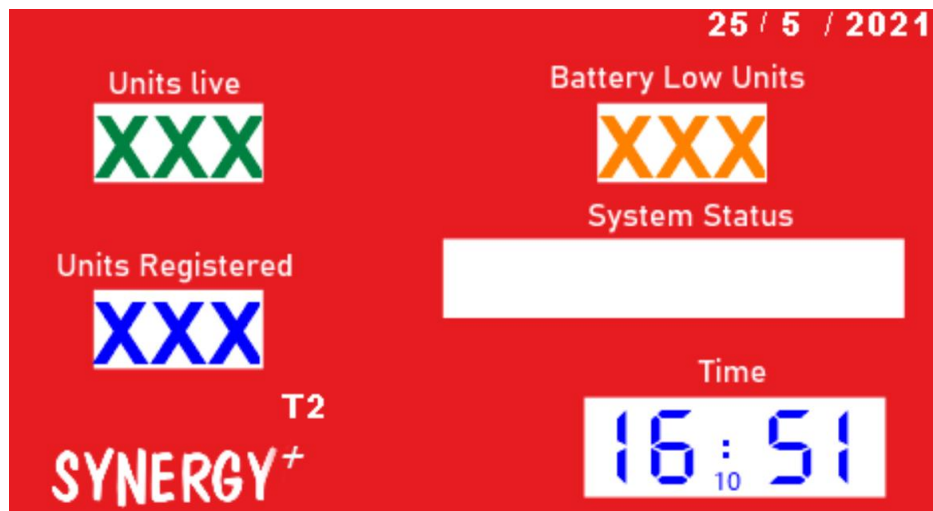

### **Units Live**

This displays how many units are connected to your system, including Call Points, Heat Detectors, Smoke Detectors, Relays & Sounder Strobes

### **Units Registered**

The number in this box displays how many devices that are paired into your system

### **Battery Low Units**

A counter to display how many units in your system that are in battery low state

### **System Status**

A scrolling display showing any messages that the system has to display

\*\*\* Please note, if the "Units Live" are lower than "Units Registered" please investigate



# EVACUATOR

Site Alarms

## Menu

To enter the menu hit button “A” and you will be presented with the following screen and options

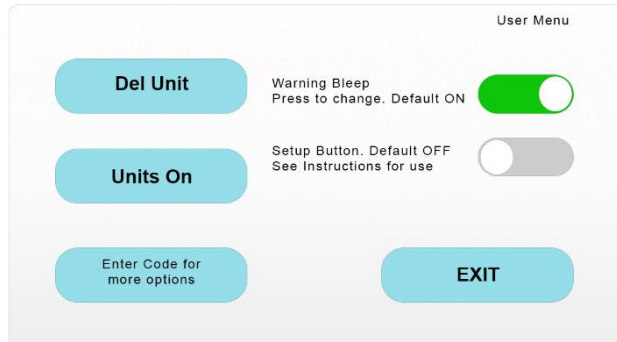

## Del Unit

If you need to delete a device from your system you will need to select the number of the device by using the arrows on the screen that is presented (as below). Once you are ready press Submit, give it a few seconds to remove. Once complete you will return to the homescreen.

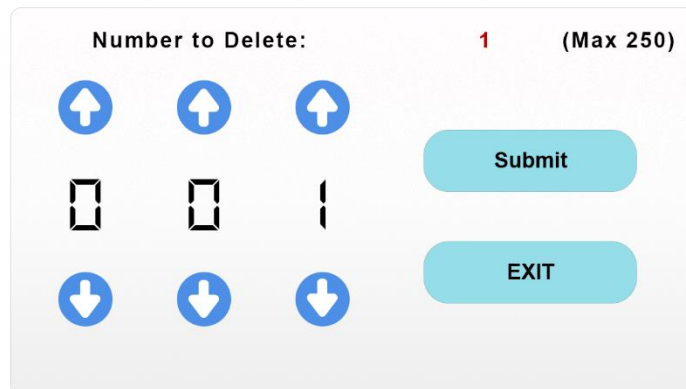

# EVACUATOR

Site Alarms

## Units On

Checking the device status on your system is easy. Hit the “Units On” button in the menu and you are presented with a grid (as below) displaying the paired units

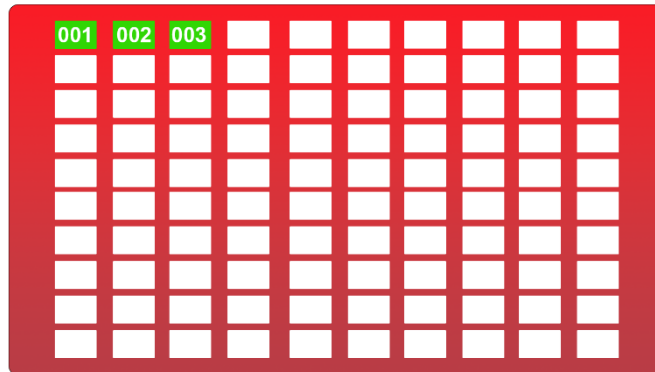

**Green** indicates the call point unit on the system and is working correctly.

**Brown** indicates that an Auto detector unit is on the system and working correctly.

**Black** indicates the unit is not working and should be investigated.

**Yellow** indicates a battery low on the unit and the battery should be replaced.

## Enter Code for more options

This is to access “Supervisor” and “Engineers” menus. You will need the relevant passcodes for this access

## Warning Beep Toggle

Default setting is On, this beep gives an audible warning when a device disconnects or is in battery low state. To Turn the warning off simply toggle across until the switch is displayed as Grey

## Pairing Devices to a Base Station

Please follow our YouTube video to assist with pairing your Devices to a Base Station, QR Code provided below



# EVACUATOR

Site Alarms

## Alarm Alert

### First Aid



The First Aid screen appears if you press the First Aid button on a call point or the star key on an Auto detector. Press the on screen “Acknowledge” button - this must be pressed and the base station will then send a message back to the unit. The pressed unit will then bleep the sounder and also flash all the LEDS on the call point.

### Fire



The screen above will appear for a fire alarm and display the number of the unit which is in alarm. Press “cancel” on the front of the unit to silence alarm.





**Evacuator 12 Month Limited Warranty**

All products manufactured by FMC (Firstmark Consultancy Limited), carry a 12-month warranty. This is a return to base warranty which includes manufacturing faults and defects, but does NOT include accidental damage, neglect, inappropriate use, any modification, or failure to follow instruction as to the, Storage, Installation, Commissioning, use or Maintenance of the goods, or (if there are none) reasonable and sensible good trade practice.

Goods returned to base that are deemed to be faulty, will, at our discretion, either be replaced, credited or repaired

All goods supplied by FMC are intended to be supplied to and used by persons within trade and business ONLY, and therefore warranties are not transferable to members of the public.

